

No. of Courses	Courses	Distance
1	North	20
2	N 11 W	81
3	N 40 W	110
4	N 30 W	80
5	S 73 W	52
6	S 40 W	37
7	South	258 1/2
		637 1/2 Total distance

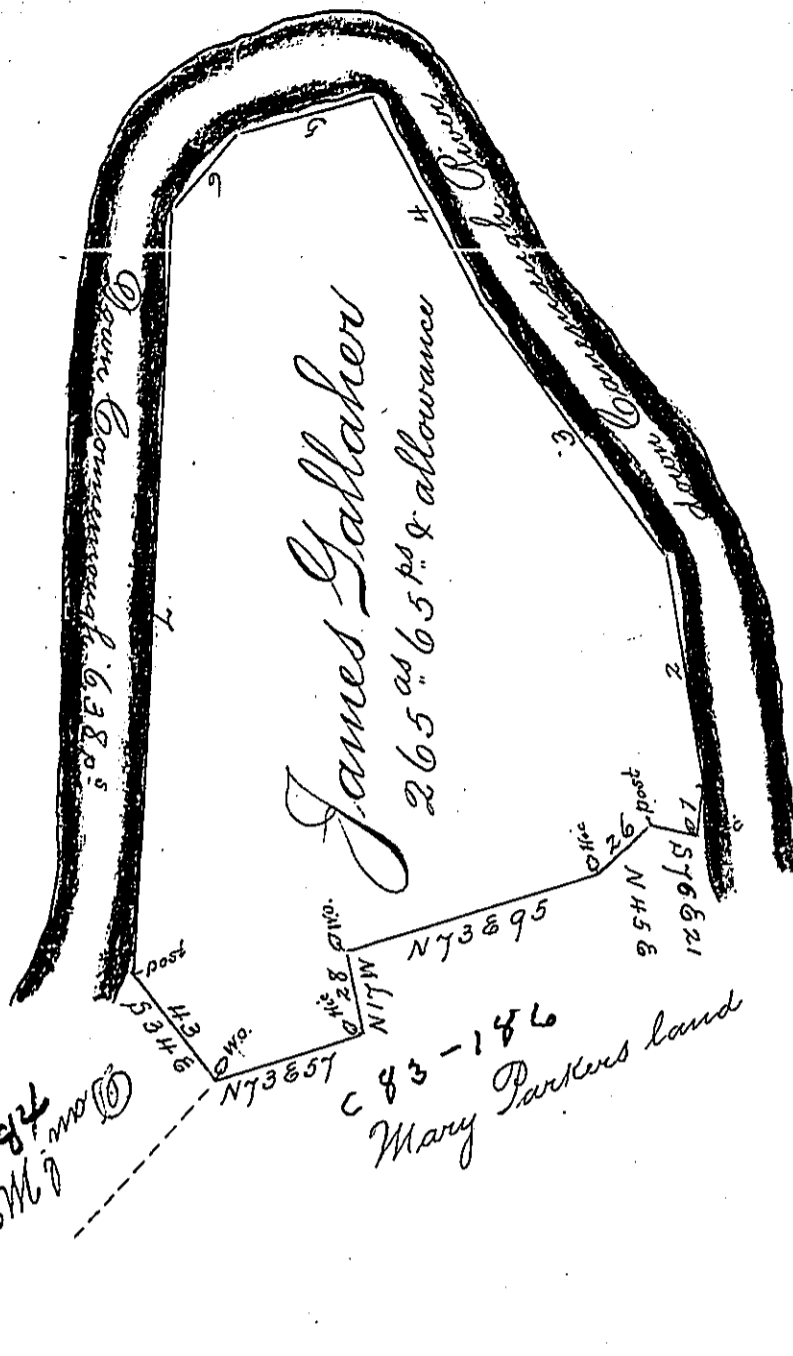

In pursuance of a warrant dated October 12th 1786 there was Survey'd for James Gallaher the above Described Tract of land containing Two Hundred and sixty five acres and allowances proportioned to six per Cent. adjoining land of Mary Parker and others in Derry Township Westmoreland County Survey'd March 20th 1787

To John Lukens Esq^r Sur^r Gen^l p John Moore D.S

IN TESTIMONY that the above is a copy of the original remaining on file in the Department of Internal Affairs of Pennsylvania, made conformably to an Act of Assembly approved the 16th day of February, 1833, I have hereunto set my Hand and caused the Seal of said Department to be affixed at Harrisburg, this sixth day of November 1900.

James W. Latta
Secretary of Internal Affairs.